



1 & 2 BHK COMFORT HOMES

- About us -

At Sheth Realty, we believe that every brick layed, shall serve us milestones for our future endeavors. Over the course of 30 years, we have built secure homes with integrity and delivered spaces that add value to life.

With our newest gem, Splendour Greens, we aim to venture into affordable housing and create an unforgettable living experience. Keeping the style and quality intact, we have curated the perfect 1 & 2 BHK apartments. Splendour Greens offers homes that are an amalgamation of comfort, efficiency and great visual aesthetics.





Life at
Splendour Greens

IN THE MIDST OF
- Nature -

Find your freedom, without leaving home.
Surround yourself with expansive greenery and serene
landscapes in an ideal place to balance life,
work and play.

Kondhwa, one of Pune's most convenient locations,
offers a perfect blend of both worlds where you can
experience the development of a metro city and the
calmness of nature. Splendour Greens is strategically
located in close proximity to Pune Camp, & Hadapsar.



SITE
-Layout-

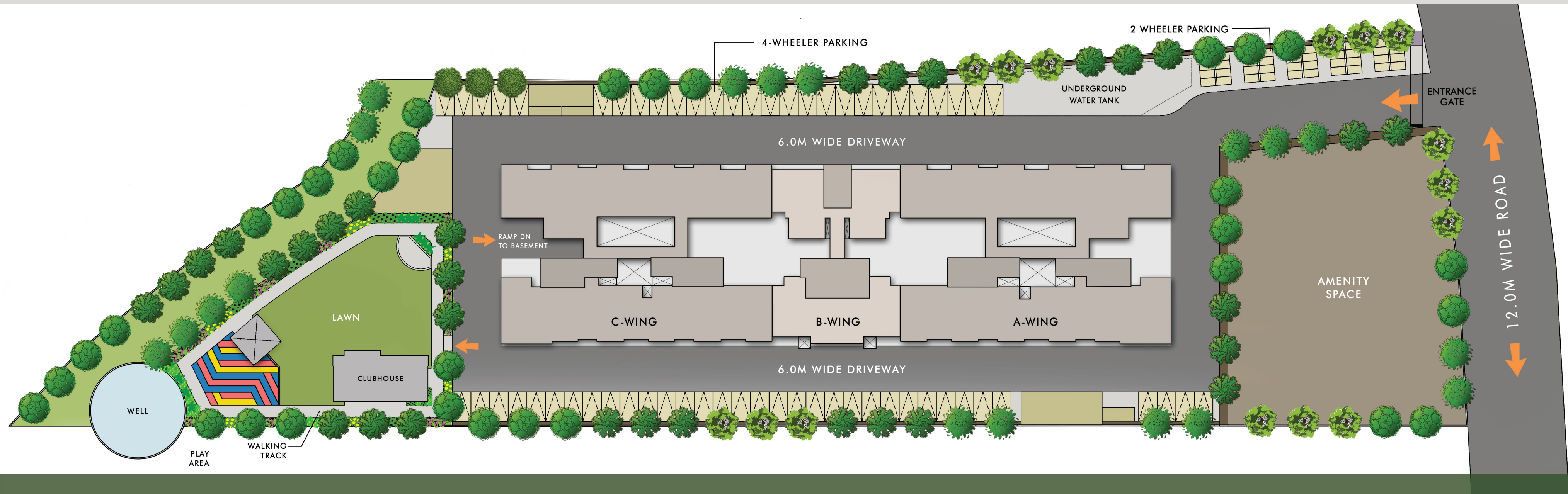

*Layout not to scale



14 STOREYS OF HOMES THAT ARE
STYLISH | SPLENDID | SAFE

Splendour Greens is meticulously planned with an expansive external layout and is designed for easy vehicular movement. Whether it's a pick up or drop, or just parking, you'll always be at ease.

Non-intrusive greens reserved for children, provide safe playing spaces. Shaded common areas and tree lined barriers offer much needed privacy. Splendour Greens features a gated community of 3 buildings surrounded with lush green landscape and host of amenities.

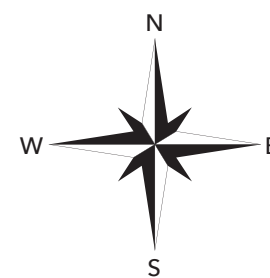



AMENITIES & *- Highlights -*

- Beautifully landscaped garden
- Planned club house facility
- Basement + Ground level parking
- Power back-up for common areas





SPLENDOUR
GREENS

AROUND US

Camp	9 Mins
Lulla Nagar	4 Mins
Market Yard	5 Mins
NIBM Road	3 Mins
Swargate	13 Mins
Hadapsar	13 Mins
Bishop's School	9 Mins
Vibgyor School	6 Mins
Delhi Public School	9 Mins
Bharati Vidyapeeth	5 Mins
Sinhgad Institutes	13 Mins
Noble Hospital	13 Mins
Corianthan Club	9 Mins

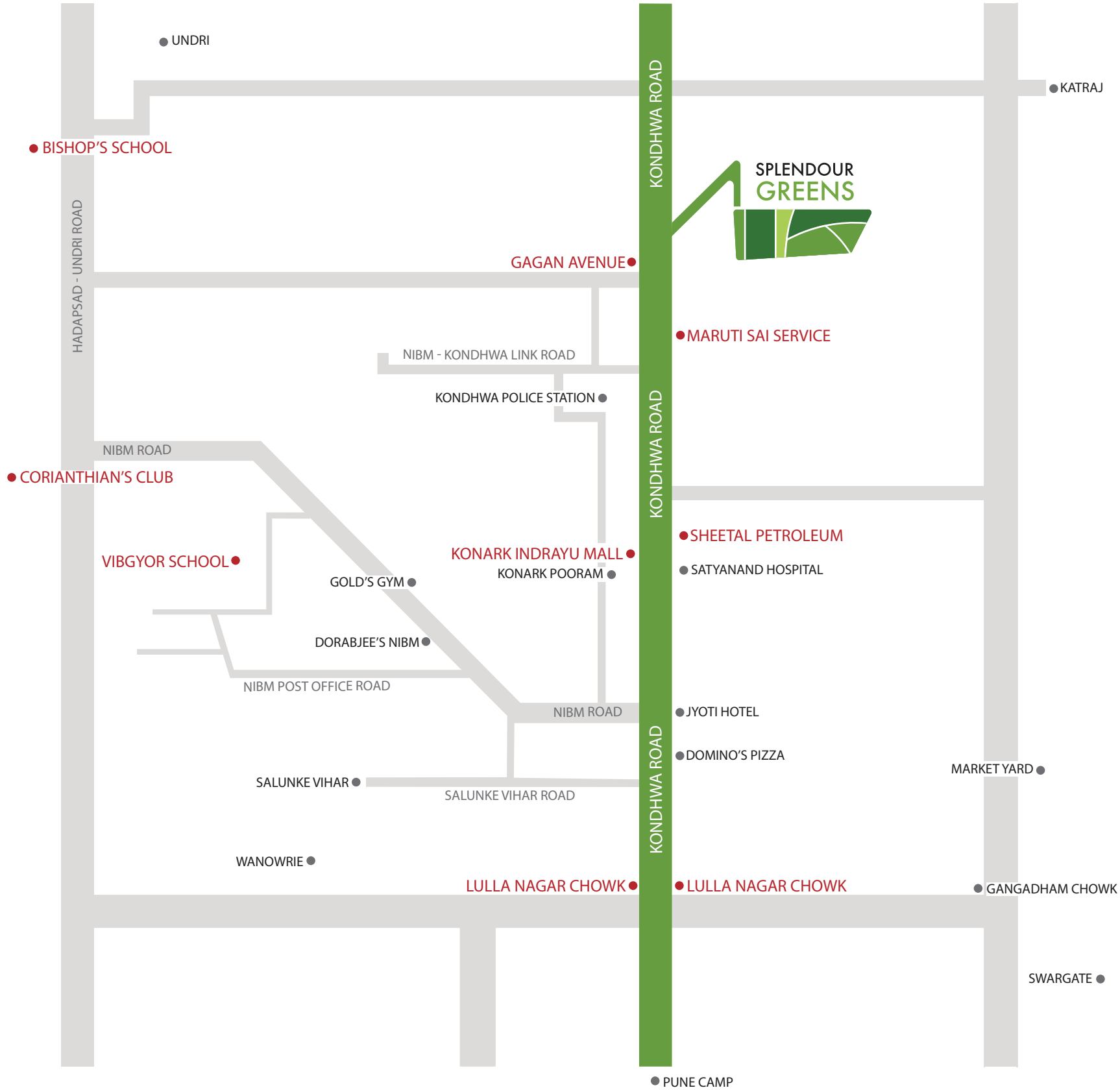

*This map is for representational purposes only. Not to scale.

PAST
- Projects -

Sheth Realty is the new age, ultra modern, technologically advanced & contemporary real estate group. We create projects that impeccably and optimally meet our client’s needs, address the safety concerns and give an incredible experience of luxury and comfort.

Here’s presenting our jewels!

- 1 Konark A Plus, Sopan Baug, Pune
- 2 Konark Campus, Viman Nagar, Pune
- 3 Konark Eureka, Kharadi, Pune
- 4 Konark Exotica, Wagholi, Pune
- 5 Konark Splendour, Wadgaon Sheri, Pune
- 6 Konark Valentine, Viman Nagar, Pune
- 7 Konark Elegance, Wadgaon Sheri, Pune
- 8 Konark Darshan, Mulund, Mumbai
- 9 Konark Empress, Worli, Mumbai

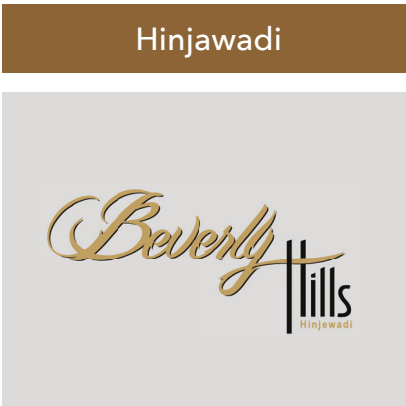
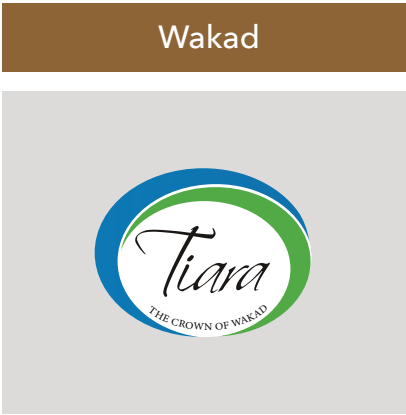



FOR INQUIRIES CONTACT: **9011554455 / 9011664455**



P52100021159

Site Address: S.No.7, Splendour Greens, Dharmawat Nagar, Next to Sai Service Station, Kondhawa (BK), Pune.

Admin Office: 202, Power Plaza, Lane-7, Koregaon Park, Pune 411001. Tel: 020-26159999, Email: sales@shethrealty.com

Disclaimer: Whilst every care has been taken in the preparation of this brochure, the promoters reserve the rights to make additions, alterations and amendments as may be necessary from time to time. The photographs and artist impressions are for reference only.

Architect: Anil Saykar.

Structural Consultant: J+W Consultants

Brochure & Graphics by: Isha Sheth (isha.sheth97@gmail.com)

PROJECT DEVELOPED BY



INTEGRITY BUILT IN

www.shethrealty.com